

Drawing



Hendi B.V.  
Steenoven 21  
3911 TX Rhenen  
The Netherlands

Batch #  
HK-170624 and  
up

Appliance part#  
**239698**

Description  
**Induction Cooker 3500 D XL**

Date	28-03-2018	Revision #	1.1
Revision	New main pcb.		

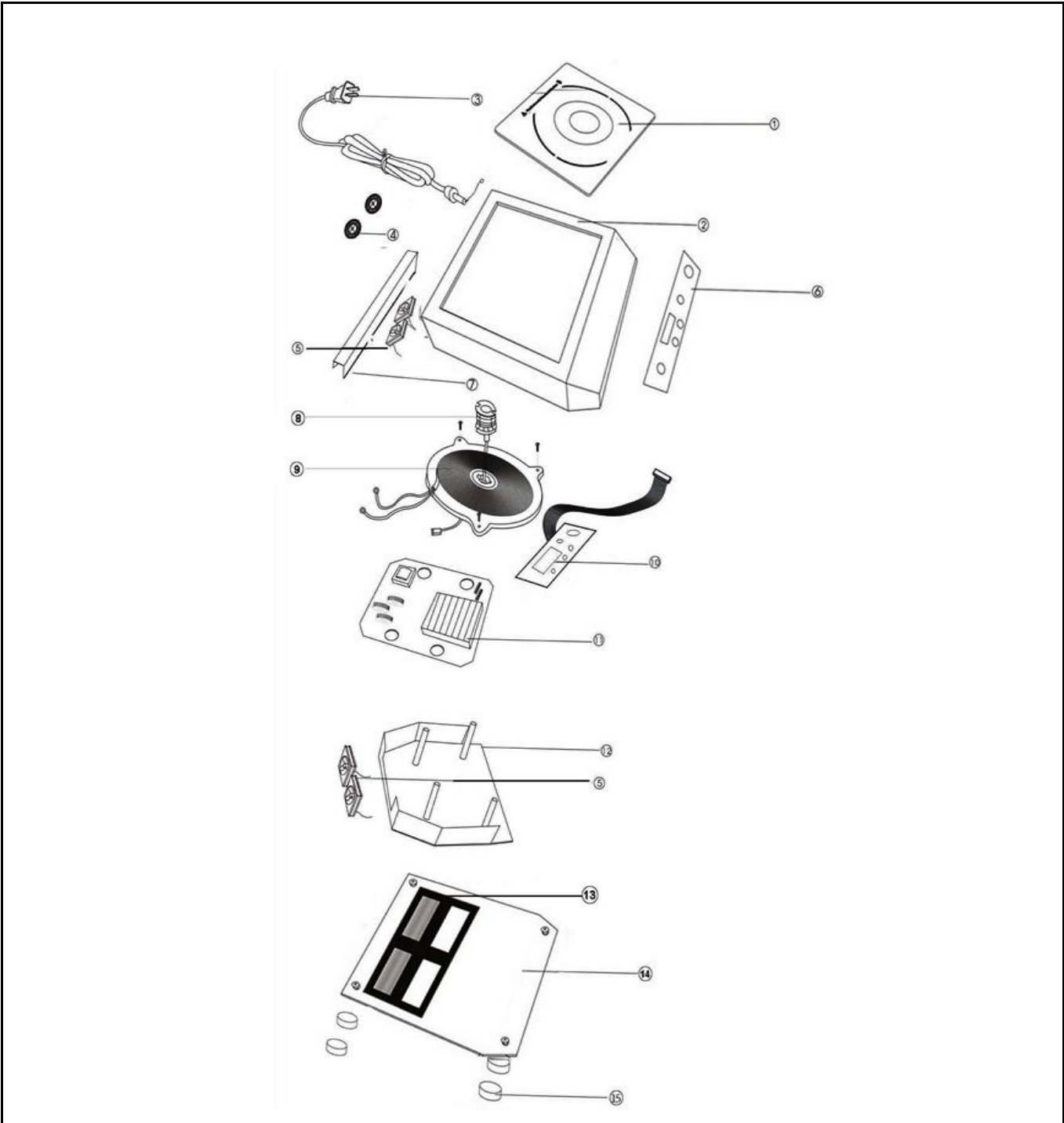

**Bill of materials (BOM)**

 <b>HENDI</b> <small>FOOD SERVICE EQUIPMENT</small>  <b>Hendi B.V.</b> Steenoven 21 3911 TX Rhenen The Netherlands	<b>Batch #</b>	<b>Appliance part#</b>
	HK-170624 and up	<b>239698</b>
	<b>Description</b>	
Induction Cooker 3500 D XL		

<b>Date</b>	28-03-2018	<b>Revision #</b>	1.1
<b>Revision</b>	New main pcb.		

Item	Description	Part#	Quantity	Remark	Picture
1	Glass plate	nss	1	Available as 942284	
2	Upper housing complete	942284	1	Incl item 1,6,7,	
3	Power cord	929353	1		
4	Cover fan	n/a	2		
5	Fan 18V	901441	4		
6	Display glass	nss	1	Available as 942284	
7	Bracket	nss	1	Available as 942284	
8	Sensor (with thermal fuse)	932582	1		
9	Main coil	942291	1		
10	Control pcb	929971	1		
11	Main pcb	944325	1		
12	Plastic bracket	n/a	1		
13	Filter	942307	1		
14	Bottom cover	n/a	1		
15	Feet	901373	4		

n/a -> not available

nss -> not sold separately

## Wiring diagram

 <b style="font-size: 2em; color: red;">HENDI</b> FOOD SERVICE EQUIPMENT  <b>Hendi B.V.</b> Steenoven 21 3911 TX Rhenen The Netherlands	<b>Batch #</b>	<b>Appliance part#</b>
	HK-170624 and up	<b>239698</b>
	<b>Description</b>	
	Induction Cooker 3500 D XL	

<b>Date</b>	28-03-2018	<b>Revision #</b>	1.1
<b>Revision</b>	New main pcb.		

